

NOTE: Before starting work, make certain that power to pump is off. Release liquid pressure on the outlet line of pump before performing maintenance. You may find it easier to remove the pump and work on a bench.

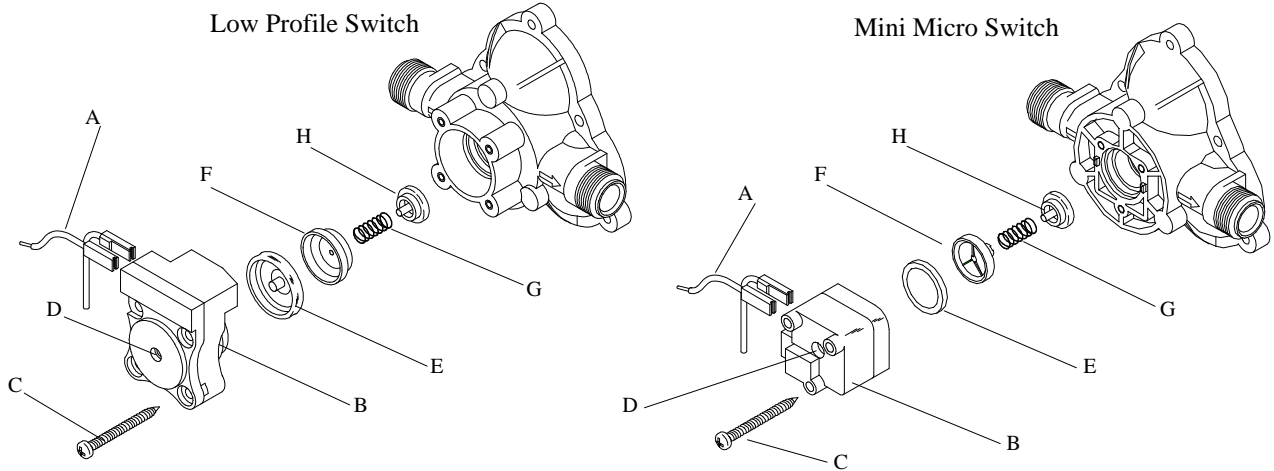

DISASSEMBLY:

1. Remove the pressure switch screws (C). Note: The screw (D) does not need to be removed or loosened to replace the switch. It is for pressure adjustment only.
2. Remove the switch assembly (B) from the pump.
3. Remove the rubber diaphragm (E).
4. The retainer (F) has been pressed into the pump housing. To remove the retainer, insert one of the switch mounting screws (C) into the center hole, turn the screw into the retainer a couple of times, and then pull the screw to lift the retainer.
5. Remove the spring (G) and the check valve (H) from the pump housing. Discard the old rubber diaphragm, retainer, and check valve.

ASSEMBLY:

1. Place the new check valve assembly (H) into pump housing (as shown) with the stem facing up. Place new spring (G) over stem of check valve assembly (H). Place new retainer (F), stem facing down, over spring (G). Press aligned parts down while placing rubber diaphragm (E) into the pump housing (over the retainer) with the stem facing up.
2. Place switch assembly (B) into position.
3. Install switch screws (C) securely.



*ISO Certified Facility



SHURflo reserves the right to update specifications, prices, or make substitutions.

SHURflo ★
5900 Katella Ave.
Cypress, CA 90630
(800) 854-3218 (562) 795-5200
FAX (562) 795-7554

SHURflo East
52748 Park Six Court
Elkhart, IN 46514-5427
(800) 762-8094
(219) 262-0478
FAX (219) 264-2169
© 2001

SHURflo Ltd.
Unit 5 Sterling Park
Gatwick Road, Crawley
West Sussex, RH10 2QT
United Kingdom
+44 1293 424000
FAX +44 1293 421880